

Notice of variation with introductory note

The Environmental Permitting (England & Wales) Regulations 2016

United Utilities Water Limited

Runcorn Wastewater Treatment Works (RUNCN)
Warrington Road
Runcorn
WA7 1QH

Variation application number

016820127/V002

Permit number

016820127

RUNCORN WASTEWATER TREATMENT WORKS

Permit number 016820127

Introductory note

This introductory note does not form a part of the notice

The following notice gives notice of the variation of an environmental permit.

This permit variation introduces the new 3 in 5 year DWF assessment and data quality conditions 3.1.5 and 3.3.10

The unique ID for the overflow giving rise to the storm discharge is **UUP01698**.

The schedules specify the changes made to the original permit.

The status log of a permit sets out the permitting history, including any changes to the permit reference number. It is not backdated before 6 April 2010.

Status log of the permit		
Description	Date	Comments
Variation determined 016820127/V001	06/12/2018	Variation of permit initiated by the Environment Agency to incorporate improvements delivered under AMP6 - EDM
Environment Agency initiated variation 016820127/V002	01/09/2025	Administrative variation to include the new dry weather flow conditions
Variation determined 016820127	17/12/2025	Varied permit issued.

End of introductory note

Notice of variation

Environmental Permitting (England and Wales) Regulations 2016

The Environment Agency in exercise of its powers under regulation 20 of the Environmental Permitting (England and Wales) Regulations 2016 varies

Permit number

016820127

Issued to

United Utilities Water Limited ("the operator")

whose registered office is

**Haweswater House
Lingley Mere Business Park
Lingley Green Avenue
Great Sankey
Warrington
WA5 3LP**

company registration number 02366678

to operate water discharge activities at

**Runcorn Wastewater Treatment Works
Warrington Road
Runcorn
WA7 1QH**

to the extent set out in the schedules.

The notice shall take effect from 17/12/2025

Name	Date
	17/12/2025

Authorised on behalf of the Environment Agency

Schedule 1 – conditions to be deleted

None

Schedule 2 – conditions to be amended

The following conditions are amended as detailed, following an Environment Agency initiated variation

3.1.5 The permitted Dry Weather Flow limit in schedule 3 table S3.1 is set at the operator's planned annual 80% exceeded daily volume discharged.

- (a) For compliance purposes an exceedance shall be recorded for a calendar year only when the limit in effect on 31 December of that calendar year is exceeded by 90% or more of the 'good' recorded Total Daily Volumes in that calendar year.
- (b) Up to and including 31 December 2025:
 - (i) If an exceedance of the Dry Weather Flow limit is recorded in a calendar year then the operator shall, as soon as is reasonably practicable, investigate the reasons for the exceedance.
 - (ii) The operator shall report the reasons for the exceedance to the Environment Agency and the steps that it proposes to take to restore compliance.
 - (iii) An exceedance of the Dry Weather Flow limit shall not be recorded as a failure of the Dry Weather Flow limit in that calendar year if the operator takes appropriate steps to restore compliance.
- (c) From the 1 January 2026 the limit has been complied with in an assessment calendar year unless;
 - (i) the limit was exceeded in the compliance assessment calendar year, and;
 - (ii) two or more exceedances have occurred in the preceding 4 calendar years.

Only exceedances from a calendar year after 31 December 2025 shall be used.

Schedule 3 – conditions to be added

The following conditions are added following an Environment Agency initiated variation:

3.3.10

- a) Total Daily Volumes shall be calculated from the average of the available 'good' 15 minute flow readings taken from midnight to midnight where;

Total Daily Volume (m3) = {Sum of 'good' readings (l/s) / number of 'good' readings} x {86,400 (s) / 1000}.

Where there are 87 or more 'good' 15 minute flow readings the Total Daily Volume shall be reported as 'good', where there are 1 – 86 'good' readings it shall be reported as 'suspect' and where there are no 'good' readings as 'missing'.

- (b) The operator shall record all failures of the flow measurement system and any other breaks in the flow record and the reasons for all issues, failures and breaks that lead to missing or suspect Total Daily Volume records and all steps taken to prevent a re-occurrence.
- (c) There shall be no more than 37 days and/or no more than 14 consecutive days with 'suspect' or 'missing' Total Daily Volumes in a calendar year, unless otherwise agreed in writing by the Environment Agency.
- (d) All 15 minute flow readings shall be flagged as 'good', 'suspect' or 'missing' using an appropriate methodology set out in the operator's flow monitoring quality management system.

Permit

The Environmental Permitting (England and Wales) Regulations 2016

Permit number

016820127

This is the consolidated permit referred to in the variation and consolidation notice for variation 016820127/V001 authorising,

United Utilities Water Limited ("the operator"),

whose registered office is

**Haweswater House
Lingley Mere Business Park
Lingley Green Avenue
Great Sankey
Warrington
WA5 3LP**

company registration number 02366678

to operate water discharge activities at

Runcorn Wastewater Treatment Works (RUNCN) (016820127)

Warrington Road

Astmoor

Runcorn

WA7 1QH

to the extent authorised by and subject to the conditions of this permit.

Name	Date
	06/12/2018

Authorised on behalf of the Environment Agency

Conditions

1 Management

1.1 General management

- 1.1.1 The operator shall manage and operate the activities:
- (a) in accordance with a written management system that identifies and minimises risks of pollution so far as is reasonably practicable, including those risks arising from operations, maintenance, accidents, incidents, non-conformances and those drawn to the attention of the operator as a result of complaints; and
 - (b) using sufficient competent persons and resources.
- 1.1.2 Records demonstrating compliance with condition 1.1.1 shall be maintained.
- 1.1.3 Any person having duties that are or may be affected by the matters set out in this permit shall have convenient access to a copy of the permit.

2 Operations

2.1 Permitted activities

- 2.1.1 The only activities authorised by the permit are the activities specified in schedule 1 table S1.1.

2.2 The site

- 2.2.1 The discharge activities shall take place at the discharge point marked on the site plan at schedule 7 to this permit, and as listed in table S3.2; and, the operating techniques that are the subject of conditions prefixed by 2.3 shall be applied at the locations shown, or otherwise described, in schedule 7.

2.3 Operating techniques

- 2.3.1 For the activity A1 referenced in schedule 1, table S1.1 the operator shall comply with the relevant requirements of the Urban Waste Water Treatment (England and Wales) Regulations 1994.
- 2.3.2 For the discharge(s) specified in table S3.3:
- (a) The discharge shall only occur when and only for as long as the flow passed forward is equal to or greater than the overflow setting indicated due to rainfall and/or snow melt.
 - (b) Off-line storm storage must be fully utilised before a discharge occurs. It shall only fill when the flow passed forward is equal to or greater than the overflow setting indicated due to rainfall and/or snow melt and shall be emptied and its contents returned to the continuation flow as soon as reasonably practicable. The minimum off-line storm storage required is specified in table S3.3.
 - (c) The discharge shall not be comminuted or macerated.
- 2.3.3 For the activity A2 referenced in schedule 1, table S1.1 where the discharge results in unsatisfactory solid matter being visible in the receiving waters or on the banks or shoreline, in the vicinity of the outfall, the operator shall take all reasonable steps to collect and remove such matter as soon as reasonably practicable.

3 Emissions and monitoring

3.1 Emissions to water

3.1.1 The limits given in schedule 3 table S3.1 shall not be exceeded.

3.1.2 The limits in schedule 3 table S3.1 to which this condition applies may be exceeded where: in any series of samples of the discharge taken at regular but randomised intervals in any period of twelve consecutive months as listed in column 1 of schedule 3A, no more than the relevant number of samples, as listed in column 2 of schedule 3A, exceed the applicable limit for that relevant parameter. For relevant parameters subject to schedule 3C the assessment is based on a fixed calendar year from 1 January to 31 December inclusive.

3.1.3

- (a) For the emission limits in schedule 3 table S3.1 to which this condition applies, no sample of the discharge taken at a time when unusual weather conditions are adversely affecting the operation of the waste water treatment works, shall be taken into account in deciding whether or not the emission limit has been complied with.
- (b) On any occasion where unusual weather conditions adversely affect the operation of the waste water treatment works, the operator shall use its best endeavours to mitigate that adverse effect.
- (c) For any sample of the discharge taken to be considered for the purposes of (a) above, the operator shall notify the Environment Agency in writing within 14 days of becoming aware that an emission limit has been exceeded. That notification shall include a full description of the unusual weather conditions and their impact on the operation of the works.

3.1.4

- (a) For the emission limits in schedule 3, table S3.1 to which this condition applies, no sample of the discharge taken at a time when abnormal operating conditions are adversely affecting the operation of the waste water treatment works, shall be taken into account in deciding whether or not the emission limit has been complied with.
- (b) On any occasion where abnormal operating conditions adversely affect the operation of the waste water treatment works, the Operator shall use its best endeavours to mitigate that adverse effect.
- (c) For any sample of the discharge taken to be considered for the purposes of (a) above, the Operator shall notify the Environment Agency in writing within 14 days of becoming aware that an emission limit has been exceeded. That notification shall include a full description of the abnormal operating conditions and their impact on the operation of the works.

3.1.5

- (a) If the measured Dry Weather Flow exceeds the permitted Dry Weather Flow limit then the operator shall, as soon as is practicable, investigate the reasons for the exceedance. The operator shall report the reasons for the exceedance to the Environment Agency and the steps that it proposes to take to restore compliance. An exceedance of the Dry Weather Flow limit shall not be recorded as a failure if the operator takes appropriate steps to restore compliance;
- (b) If the measured Dry Weather Flow exceeds the permitted Dry Weather Flow limit because of unusual rainfall during the 12-month period, then it will not be recorded as a failure of the Dry Weather Flow limit. For the purposes of this condition, unusual rainfall shall mean rainfall that causes significantly higher sewage flows during the three-month period that normally records the lowest flows;
- (c) The permitted Dry Weather Flow limit is set at the operator's planned annual 80% exceeded flow;

- (d) For compliance with this permit, the measured Dry Weather Flow is that total daily volume that is exceeded by 90% of the recorded measured total daily volume values in any period of 12 months; and
- (e) For unusual rainfall to be considered, the operator shall notify the Environment Agency and provide supporting evidence as part of the normal specified data returns.

3.2 Emissions of substances not controlled by emission limits

- 3.2.1 For the activity A1 referenced in schedule 1, table S1.1 the operator shall take appropriate measures to minimise so far as reasonably practicable the polluting effects of the emissions of substances in the discharge not controlled by emission limits (excluding odour).

3.3 Monitoring

- 3.3.1 The operator shall, unless otherwise agreed in writing by the Environment Agency, undertake the monitoring specified in the following tables in schedule 3 to this permit:
- (a) point source emissions specified in tables S3.1 and S3.4;
 - (b) inlet quality specified in tables S3.1 and S3.4
- 3.3.2 The operator shall maintain records of all monitoring required by this permit.
- 3.3.3 Monitoring equipment, techniques, personnel and organisations employed for the emissions monitoring programme and the environmental or other monitoring specified in condition 3.3.1 shall have either MCERTS certification or MCERTS accreditation (as appropriate), where available, unless otherwise agreed in writing by the Environment Agency.
- 3.3.4 Accessible monitoring points shall be provided and maintained to enable the emissions monitoring programme and/or other monitoring to be carried out at the monitoring points specified in table S3.4 of schedule 3 and shown marked on the site plan in schedule 7.
- 3.3.5 The monitoring programme for the parameters subject to schedule 3B shall be:
- (a) pre-scheduled to cover a calendar year and the programme recorded before the start of a calendar year sample period; and
 - (b) spot samples collected at approximately equal intervals during the year, including samples from different days of the week and different times. Approximately 10% of samples should be outside the normal sampling window which is 9am-3pm, Monday to Friday.
- 3.3.6 After becoming aware, or following a notification that a sample has not been taken on the schedule 3B Monitoring Programme pre-scheduled date, or is lost, or a result for that sample cannot be reported, the operator shall record the details and reschedule the sample.
- 3.3.7 The monitoring programme for the parameters subject to schedule 3C shall be:
- (a) pre-scheduled before each calendar year;
 - (b) Unless otherwise agreed in writing by the Environment Agency, the operator shall submit the monitoring programme for the following calendar year to the Environment Agency before the 1st of December; and
 - (c) samples must be collected at approximately equal intervals during the year from different days of the week and approximately 10% of samples should be taken at weekends.
- 3.3.8 Unless otherwise agreed in writing by the Environment Agency, after becoming aware, or following notification that a sample has not been taken on the schedule 3C Monitoring Programme pre-scheduled date, or is lost, or a result for that sample cannot be reported, the operator shall notify the Environment Agency of the missed event and the reschedule date as soon as reasonably practicable.

- 3.3.9 For the activity A2 referenced in schedule 1, table S1.1 an event duration monitoring system shall be installed and maintained, as far as reasonably practicable so as to give the operator data available of discharge occurrence (start and stop) at the frequency defined in table S3.1.

4 Information

4.1 Records

- 4.1.1 All records required to be made by schedule 3, 4 and 5 to this permit shall:
- (a) be legible;
 - (b) be made as soon as reasonably practicable;
 - (c) if amended, be amended in such a way that the original and any subsequent amendments remain legible, or are capable of retrieval; and
 - (d) be retained, unless otherwise agreed in writing by the Environment Agency, for at least 6 years from the date when the records were made.
- 4.1.2 The operator shall maintain convenient access, in either electronic or hard copy, to the records, plan and management system required to be maintained by this permit.

4.2 Reporting

- 4.2.1 The operator shall send all reports and notifications required by the permit to the Environment Agency using the contact details supplied in writing by the Environment Agency.
- 4.2.2 Within the time period after the end of the reporting period specified in schedule 4 table S4.1 the operator shall, unless otherwise agreed in writing by the Environment Agency, submit reports of the monitoring and assessment carried out in accordance with the conditions of this permit, as follows:
- (a) in respect of the parameters and monitoring points specified in schedule 4 table S4.1;
 - (b) for the reporting periods specified in schedule 4 table S4.1 and using the forms specified in schedule 4 table S4.2; and
 - (c) giving the information from such results and assessments as may be required by the forms specified in those tables.

4.3 Notifications

- 4.3.1 The Environment Agency shall be notified as soon as reasonably practicable following detection, within the site of the regulated facility of:
- (a) any malfunction, breakdown or failure of equipment or techniques, accident, or emission of a substance not controlled by an emission limit which has caused, is causing or may cause significant pollution; and
 - (b) any breach of a limit specified in schedule 3 table S3.1 (including individual exceedances of limits which are covered by condition 3.1.2).

Any other significant adverse environmental effects, which may have been caused by the activity, shall also be notified to the Environment Agency as soon as reasonably practicable following detection.

- 4.3.2 The information provided under condition 4.3.1 shall be supported by sending the information listed in schedule 5 to this permit within the time period specified in that schedule.
- 4.3.3 Where the Environment Agency has requested in writing that it shall be notified when the operator is to undertake monitoring and/or spot sampling specified in schedule 3B/3C, the operator shall inform

the Environment Agency when the relevant monitoring and/or spot sampling is to take place. The operator shall provide this information to the Environment Agency at least 14 days before the date the monitoring is to be undertaken.

- 4.3.4 The Environment Agency shall be notified within 14 days of the occurrence of the following matters, except where such disclosure is prohibited by Stock Exchange rules:

Where the operator is a registered company:

- (a) any change in the operator's trading name, registered name or registered office address; and
- (b) any steps taken with a view to the operator going into administration, entering into a company voluntary arrangement or being wound up.

Where the operator is a corporate body other than a registered company:

- (a) any change in the operator's name or address; and
- (b) any steps taken with a view to the dissolution of the operator.

- 4.3.5 For the activity A1 referenced in schedule 1, table S1.1 where the operator proposes to make a change in the nature of the activity by increasing the concentration of, or the addition of, or allowing the introduction of, a substance to the activity to an extent that the operator considers could have a significant adverse environmental effect on the receiving waters, and the change is not permitted by emission limits specified within schedule 3 table S3.1 or the subject of an application for approval under the EP Regulations or under the terms of this permit:

- (a) the Environment Agency shall be notified in writing at least 14 days before the increase or addition or allowing the introduction; and
- (b) the notification shall contain a description of the proposed change.

- 4.3.6 The operator shall notify the Environment Agency, as soon as practicable after receipt of a telemetry warning, that operation of the combined sewer overflow has taken place.

- 4.3.7 For the activity A1 referenced in schedule 1, table S1.1 the operator shall inform the Environment Agency in writing of any change, or proposed change, to the population equivalent such as would make a material change to the application of the Regulations and shall, on request, inform the Environment Agency in writing of the actual population equivalent.

4.4 Interpretation

- 4.4.1 In this permit the expressions listed in schedule 6 shall have the meaning given in that schedule.
- 4.4.2 In this permit references to reports and notifications mean written reports and notifications, except where reference is made to notification being made "as soon as reasonably practicable", in which case it may be provided by telephone.

Schedule 1 – Operations

Table S1.1 Activities		
Activity reference	Description of activity	Limits of specified activity
A1	Discharge of secondary treated sewage effluent via Outlet	N/A
A2	Discharge of settled storm sewage via Outlet	N/A

Schedule 2 – Waste types, raw materials and fuels

Schedule 2 not in use.

Schedule 3 – Emissions and monitoring

Table S3.1 Point Source emissions to water (other than sewer) – emission limits and monitoring requirements							
Effluent(s) and discharge point(s)	Parameter	Limit (including unit)	Reference Period	Limit of effective range	Monitoring frequency	Compliance Statistic	
A1 Secondary treated sewage effluent via Outlet 1	Dry weather flow	17,749 m ³ /day	Total daily volume	N/A	Continuous	Condition 3.1.5 applies	
	15-minute instantaneous or averaged flow	No limit set. Record as l/s	15 minute	N/A	Continuous	N/A	
	ATU-BOD as O ₂	30 mg/l	Instantaneous (spot sample)	N/A	As specified in schedule 3B	Look up table (Conditions 3.1.2 and 3.1.3 apply)	
	ATU-BOD as O ₂	64 mg/l	Instantaneous (spot sample)	N/A	As specified in schedule 3B	Maximum (Condition 3.1.3 applies)	
	Suspended solids (measured after drying at 105°C)	45 mg/l	Instantaneous (spot sample)	N/A	As specified in schedule 3B	Look up table (Conditions 3.1.2 and 3.1.3 apply)	
	Visible oil or grease	No significant trace present so far as is reasonably practicable	Instantaneous (visual examination)	N/A	N/A	No significant trace (Condition 3.1.3 applies)	
	ATU-BOD as O ₂ (UWWTR)	Minimum of 70 % removal compared to influent	24 hour composite	24 hour composite	To be compliant a sample has to meet the 70% removal standard or the 25 mg/l limit not both	As specified in schedule 3C	Look up table (Conditions 3.1.2 and 3.1.4 apply)
	ATU-BOD as O ₂ (UWWTR)	25 mg/l					
	ATU-BOD as O ₂ (UWWTR)	50 mg/l	24 hour composite	24 hour composite	This limit does not apply if a sample has met the 70% removal standard	As specified in schedule 3C	Maximum (Condition 3.1.4 applies)

Table S3.1 Point Source emissions to water (other than sewer) – emission limits and monitoring requirements						
Effluent(s) and discharge point(s)	Parameter	Limit (including unit)	Reference Period	Limit of effective range	Monitoring frequency	Compliance Statistic
	COD as O ₂ (UWWTR)	Minimum of 75 % removal compared to influent	24 hour composite	To be compliant a sample has to meet the 75% removal standard or the 125 mg/l limit not both	As specified in schedule 3C	Look up table (Conditions 3.1.2 and 3.1.4 apply)
	COD as O ₂ (UWWTR)	125 mg/l				
	COD as O ₂ (UWWTR)	250 mg/l	24 hour composite	This limit does not apply if a sample has met the 75% removal standard	As specified in schedule 3C	Maximum (Condition 3.1.4 applies)
A2 Settled storm sewage via Outlet	Settled storm sewage discharge event duration monitoring (discharge / no discharge)	N/A	N/A	Condition 3.3.3 does not apply	15 minute	N/A
	Settled storm sewage discharge start and end times	N/A	N/A	Condition 3.3.3 does not apply	Whenever a discharge occurs	N/A
	Settled storm sewage discharge event duration monitoring status (operational / not operational)	N/A	N/A	Condition 3.3.3 does not apply	15 minute	N/A

Effluent Name	Discharge Point	Discharge point NGR	Receiving water/Environment
A1 Secondary treated sewage effluent	Final Effluent Outlet	SJ 5412 8383	Manchester Ship Canal (tidal)
A2 Settled storm sewage	Settled Storm Outlet	SJ 5397 8377	Manchester Ship Canal (tidal)

Effluent(s) and discharge point(s)	Description of discharge	Overflow setting l/s	Minimum storage capacity m³ (off-line)
A2 Settled storm sewage via Outlet 1	Settled storm sewage	625	3,432

Effluent(s) and discharge point(s)	Monitoring type	Monitoring point NGR	Monitoring point reference
A1 Secondary treated sewage effluent via Outlet	UWWTR influent sampling	SJ 5406 8354	UWWT Influent Sample Point
	UWWTR effluent sampling	SJ 5412 8383	Final Effluent Outlet and Sample Point
	Effluent sampling	SJ 5412 8383	Final Effluent Outlet and Sample Point
	MCerts flow monitoring	SJ 5416 8379	MCERTS Flow Monitoring Point
A2 Settled storm sewage via Outlet	Effluent sampling	SJ 54009 83770	Settled Storm Overflow Sample Point
	Event duration monitoring	SJ 54280 83703	EDM Monitoring Point

Schedule 3A - Look up table

Look up table	
Number of samples taken in any period of 12 months	Maximum number of samples permitted to exceed limit for given parameter
4-7	1
8-16	2
17-28	3
29-40	4
41-53	5
54-67	6
68-81	7
82-95	8
96-110	9
111-125	10
126-140	11
141-155	12
156-171	13
172-187	14
188-203	15
204-219	16
220-235	17
236-251	18
252-268	19
269-284	20
285-300	21
301-317	22
318-334	23
335-350	24
351-365	25

Schedule 3B - OSM tier 2 sampling frequency

Tier 2 Category	Parameter	'Normal frequency' of samples per year	Reduced Sampling frequency after 12 consecutive months of numeric permit compliance, samples per year or pro rata over the remainder of a year	On numeric limit failure return to normal frequency as soon as reasonably practicable, samples per 12 months	Out of hours samples
> 5m3/d (but not in tier 3) with numeric limits for ammoniacal nitrogen (expressed as N), nutrients, hazardous pollutants, UWWTR self monitoring	Sanitary	12	6	12	For 12 samples 1 out of hours sample per annum, for 6, 1 every 2 years on average
	Non sanitary	6	6	6	
>20 m3/d (but not in tier3) with numeric limits for one or more of biochemical oxygen demand or suspended solids or pH or temperature only.	Sanitary	12	4	12	For 12 samples 1 out of hours sample per annum, for 4, 1 every 3 years on average

Schedule 3C – Urban Waste Water Treatment Regulations sampling frequency

Population equivalent	Samples per year	Reduced sampling frequency after a year without an UWWTR exceedance or failure, samples per year	Following an UWWTR exceedance or failure return to the higher frequency in the year that follows, samples per year
2,000 to 9,999	12	4	12
10,000 to 49,999	12	N/A	N/A
50,000 or over	24	N/A	N/A

Schedule 4 – Reporting

Parameters, for which reports shall be made, in accordance with conditions of this permit, are listed below.

Table S4.1 Reporting of monitoring data			
Parameter	Monitoring point reference	Reporting period	Period begins
Dry Weather Flow (daily flows total)	MCERTS Flow Monitoring Point	Annually Report to be submitted within 2 months of the end of the calendar year	1 January
15-minute flow	MCERTS Flow Monitoring Point	Reports to be provided to the Environment Agency upon request Report to be submitted within 28 days unless otherwise specified in writing by the Environment Agency	Upon request by the Environment Agency
UWWTR - ATU-BOD as O ₂ , COD as O ₂	UWWT Influent Sample Point Final Effluent Outlet and Sample Point	Monthly Report to be submitted within 28 days	1st of month
Operator Self Monitoring - ATU-BOD as O ₂ , suspended solids (measured after drying at 105°C)	Final Effluent Outlet and Sample Point	Quarterly Report to be submitted within 28 days	1st of month
Operator Self Monitoring summary report	Final Effluent Outlet and Sample Point	Annually Report to be submitted within 2 months of the end of the calendar year	1 January
Settled storm sewage discharge start and end times	EDM Monitoring Point	Reports to be provided to the Environment Agency upon request Report to be submitted within 28 days unless otherwise specified in writing by the Environment Agency	Upon request by the Environment Agency
Settled storm sewage discharge start and end times	EDM Monitoring Point	Annually Report to be submitted within 2 months	1 January
Settled storm sewage discharge event duration monitoring status (operational / not operational)	EDM Monitoring Point	Annually Report to be submitted within 2 months	1 January

Table S4.2 Reporting forms	
Parameter	Reporting format
Dry Weather Flow (daily flows total)	WISKI electronic format specified by the Environment Agency
15-minute flow	WISKI electronic format specified by the Environment Agency
UWWTR – ATU-BOD as O ₂ , COD as O ₂	Electronic format specified by the Environment Agency
OSM - ATU-BOD as O ₂ , suspended solids (measured after drying at 105°C),	Quarterly - Electronic format specified by the Environment Agency
Operator Self Monitoring summary report	Annually - Summary report of compliance with the monitoring programme specified in Table S3.1 and schedule 3B in a format specified by the Environment Agency
Settled storm sewage discharge start and end times	Form as agreed in writing by the Environment Agency
Settled storm sewage discharge start and end times	Annual summary report or other form as agreed in writing by the Environment Agency Number of and total duration of counted spills for all spills.
Settled storm sewage discharge event duration monitoring status (operational / not operational)	Annual summary report or other form as agreed in writing by the Environment Agency Percentage of time in the reporting period that the event duration monitoring equipment was operational.

Schedule 5 – Notification

These pages outline the information that the operator must provide.

Units of measurement used in information supplied under Part A and B requirements shall be appropriate to the circumstances of the emission. Where appropriate, a comparison should be made of actual emissions and authorised emission limits.

If any information is considered commercially confidential, it should be separated from non-confidential information, supplied on a separate sheet and accompanied by an application for commercial confidentiality under the provisions of the EP Regulations.

Part A

Permit Number	
Name of operator	
Location of Facility	
Time and date of the detection	

(a) Notification requirements for any malfunction, breakdown or failure of equipment or techniques, accident, or emission of a substance not controlled by an emission limit which has caused, is causing or may cause significant pollution	
To be notified within 7 days of detection unless otherwise agreed in writing by the Environment Agency	
Date and time of the event	
Reference or description of the location of the event	
Description of where any release into the environment took place	
Substances(s) potentially released/type or nature of sewage released	
Best estimate of the quantity or rate of release of substances and/or duration of discharge	
Best estimate of the environmental impact of the discharge	
Measures taken, or intended to be taken, to stop any emission	
Description of the failure or accident.	

(b) Notification requirements for the breach of a limit specified in schedule 3 table S3.1 (including individual exceedances of limits which are covered by condition 3.1.2)	
The information specified below is to be notified to the Environment Agency as soon as reasonably practicable following detection.	
Monitoring point reference/ source	
Self monitoring regime (where relevant)	e.g. OSM/UWWTR
Type of failure	e.g. LUT failure/LUT exceedance/upper tier/other
Date of sample/event	
Parameter	
Result and units	
Limit and units	

(c) Notification requirements for the detection of any significant adverse environmental effect	
To be notified within 24 hours of detection	
Description of where the effect on the environment was detected	
Substances(s) detected	
Concentrations of substances detected	
Date of monitoring/sampling	

Part B – to be submitted as soon as reasonably practicable unless otherwise agreed in writing by the Environment Agency

Any more accurate information on the matters for notification under Part A.	
Measures taken, or intended to be taken, to prevent a recurrence of the incident/breach/exceedance	
Measures taken, or intended to be taken, to rectify, limit or prevent any pollution of the environment which has been or may be caused by the emission	

Name*	
Post	
Signature	
Date	

* authorised to sign on behalf of the operator

Schedule 6 – Interpretation

"abnormal operating conditions" include but are not limited to, the circumstances described in Regulation 40(1) of, or paragraph 6(5) of Schedule 21 to, the Environmental Permitting Regulations 2016 (illegal discharge to sewer), unusual weather, or during a defined period where the permit authorising the permitted activity has been varied for reasons such as capital works construction.

"accident" means an accident that may result in pollution.

"annually" means once every year.

"application" means the application for this permit, together with any additional information supplied by the operator as part of the application and any response to a notice served under Schedule 5 to the EP Regulations.

For the activity A1 referenced in schedule 1, table S1.1 "appropriate measures" for the purposes of the emission of substances not controlled by emission limits condition (condition 3.2.1) do not require the operator to undertake treatment to a level beyond that specified in schedule 1 table S1.1, or to carry out routine monitoring for substances not controlled by emission limits.

"ATU-BOD as O₂" means the biochemical oxygen demand (measured after 5 days at 20°C with nitrification suppressed by the addition of allylthiourea).

"COD as O₂" means the chemical oxygen demand (measured using the standard dichromate procedure).

"emissions of substances not controlled by emission limits" means emissions of substances to air, water or land from the permitted activities, which are not controlled by an emission limit.

"EP Regulations" means The Environmental Permitting (England and Wales) Regulations SI 2016 No.1154 and words and expressions used in this permit which are also used in the Regulations have the same meanings as in those Regulations.

"MCERTS" means the Environment Agency's Monitoring Certification Scheme.

"minimum screen capacity flow" means the minimum flow passed through the screens to the outfall when the screen bypass operates.

"monitoring frequency" as used in Table S3.1 in the context of Event Duration Monitoring is the temporal interval at which a change of state between no discharge and discharge is to be detected.

"overflow" for the purposes of schedule 7, means any weir or orifice or other means via which flow in excess of its overflow setting is diverted from the continuation sewer when it is caused by rainfall and or snowmelt.

"overflow setting" means the minimum flow passed forward to the continuation flow when the overflow operates.

"quarter" means a calendar year quarter commencing on 1 January, 1 April, 1 July or 1 October.

"significant pollution" means a category 1 or category 2 incident indicated by the Common Incident Classification Scheme (CICS).

"spill" one or more overflow events within a period of 12 hours or less will be considered to be one spill, one or more overflow events extending over a period of greater than 12 hours up to 36 hours will be considered to be 2 spills. Each subsequent 24 hour duration counts as 1 additional spill and the whole of the 24 hour block is included.

"unusual weather conditions" includes, but is not limited to:

- low ambient temperatures, or the freezing of mechanical equipment in the works;
- significant snow deposits;
- tidal or fluvial flooding;
- weather conditions causing unforeseen loss of power supply to the sewage treatment that could not be ameliorated by the reasonable provision and operation of standby generation facilities.

"Urban Waste Water Treatment (England and Wales) Regulations 1994 (UWWTR)" means Urban Waste Water Treatment (England and Wales) Regulations 1994 SI 2841 and the words and expressions used in this permit which are also used in the Regulations have the same meanings as in those Regulations.

"year" means calendar year ending 31 December.

Schedule 7 – Site plan

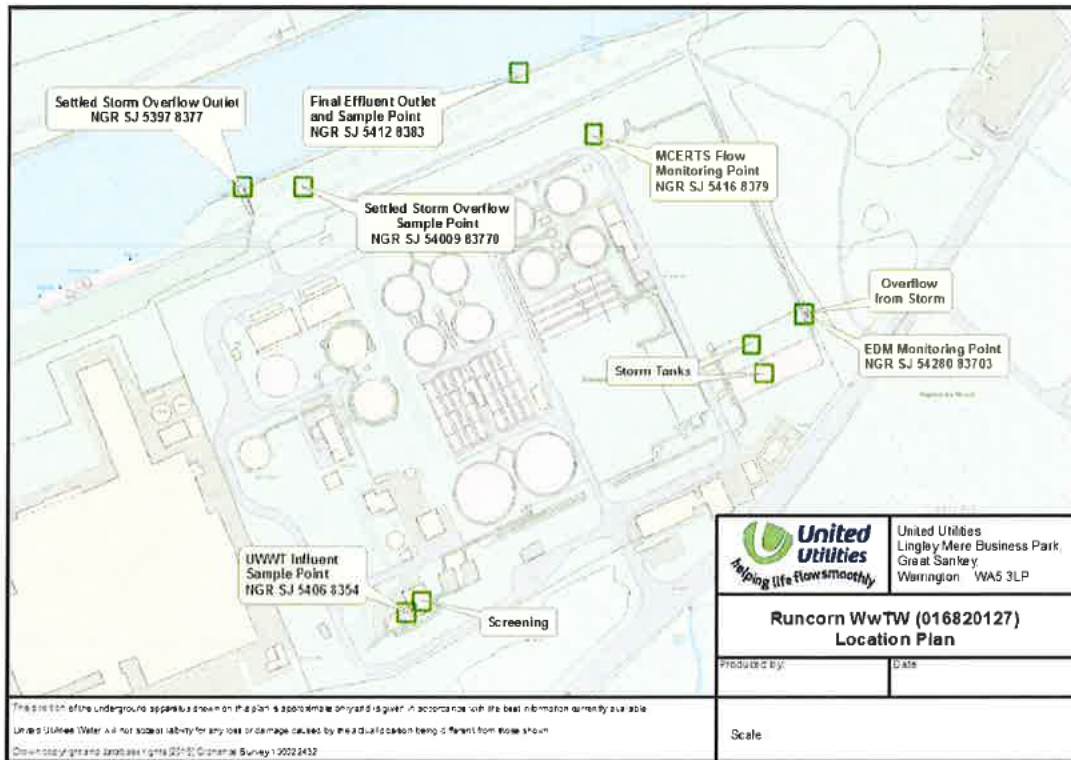

Reproduced by permission of the operator

END OF PERMIT